



Murray Edwards
College
University of Cambridge



Buckingham House Foyer

With an impressive granite reception desk and servery, the attractive foyer is an ideal place to welcome delegates and for networking and catering. Sliding doors lead to an outdoor deck.

Please discuss any requirements for posters, sponsors or exhibitors with us in advance, as additional equipment or furniture affects capacity.

A.V. equipment

Microphones and speakers are available for announcements or background music

KEY

- Light switches
- A.V. point
- Double plug socket
- Single plug socket
- Telephone
- Cloakroom
- Entrance door
- Pillars

Clear layout 140

Foyer dimensions
20.5 m x 6.5 m (133m²)

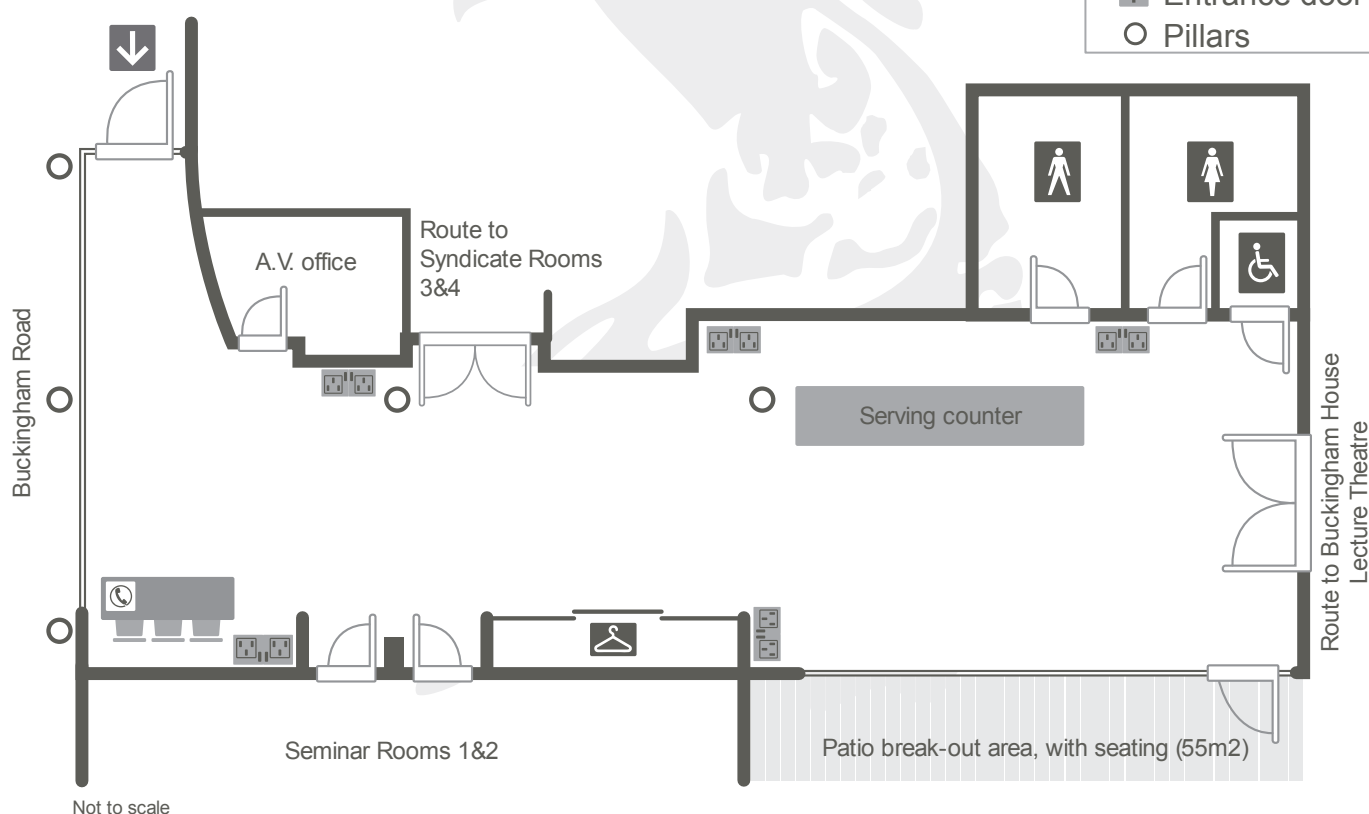

Not to scale

Break out spaces for use with Buckingham House

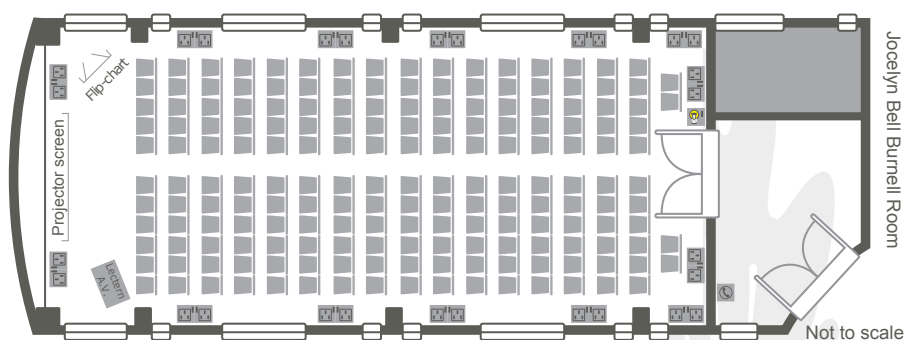

Long Room
Theatre style **180**

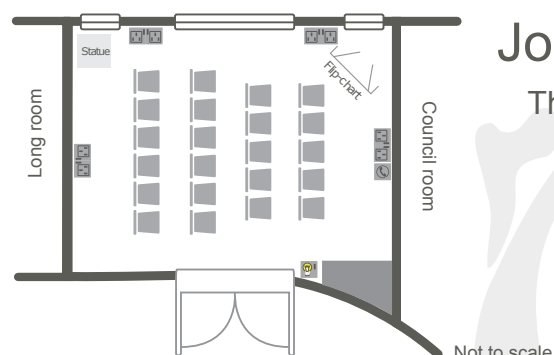

Jocelyn Bell Burnell Room
Theatre style **24**

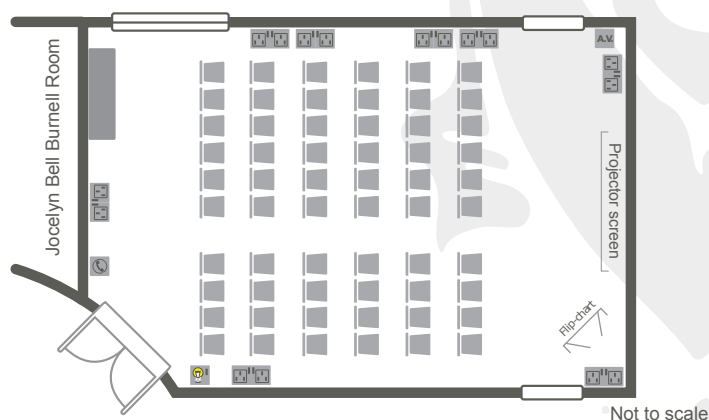

Council Room
Theatre style **50**

*Please contact us for more information
on booking these rooms.*

events@murrayedwards.cam.ac.uk
www.murrayedwardsevents.com

Parking

70 parking spaces are available at our car park accessed via Storeys' Way. Spaces are on a first-come, first-served basis.

Location

The Foyer is located on the ground floor of Buckingham House.

A detailed College map is available on our website, or from the Porters' Lodge.

Fire Assembly Point

In the unlikely event of a fire, please note the Fire Assembly Point is on the front entrance, near the Porters' Lodge.

Other information

This room is fully accessible