



**Murray Edwards College**  
University of Cambridge

## Dining in the Dome

A stunning space that will make your guests say “wow”. This room can be set up in banquet or cabaret style and can include a dance floor and bar, depending on your numbers.

**Cabaret 120**  
with dancefloor and bar  
*no top table*

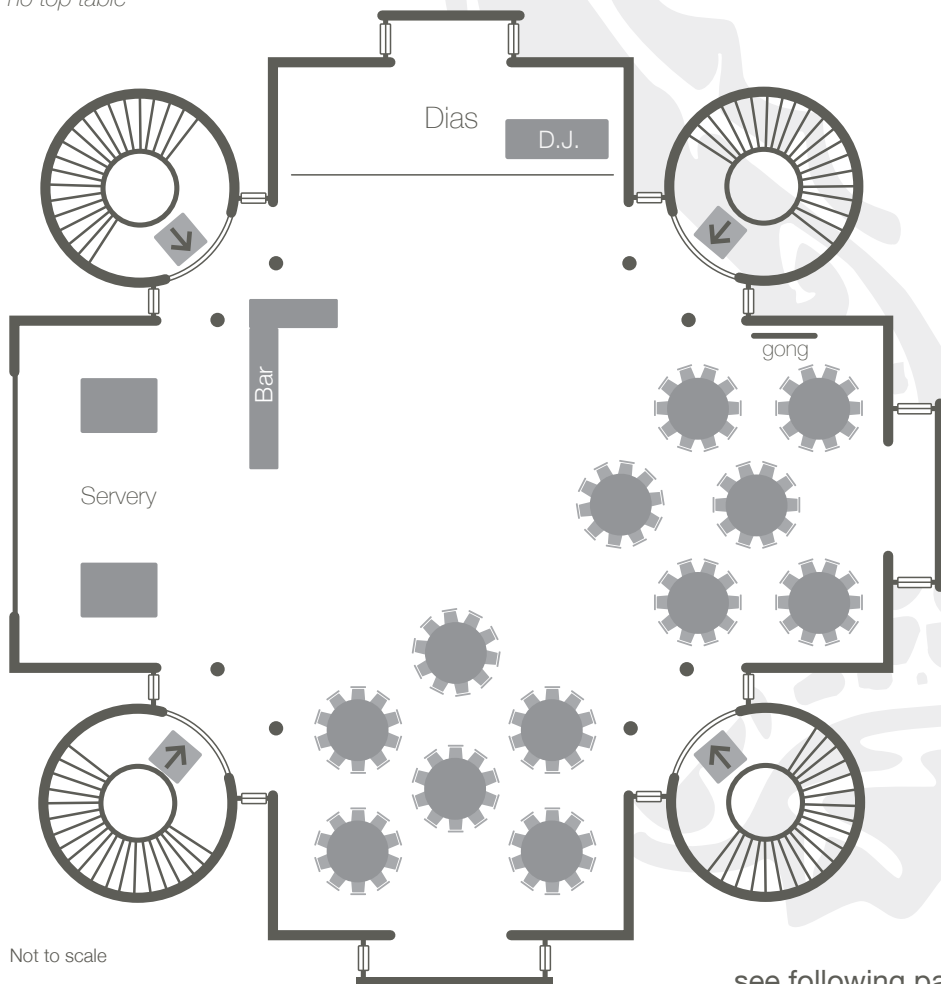

Not to scale

**A.V. equipment**  
Portable projector, screen and audio are available  
Speakers for music

- Light switches
- A.V. point
- Double plug socket
- Single plug socket
- Pillar
- Entrance door

**Room area**  
420m<sup>2</sup>

see following pages for additional layout options

Alternative room layouts - part 1

**Seated buffet 240**

*with top table*

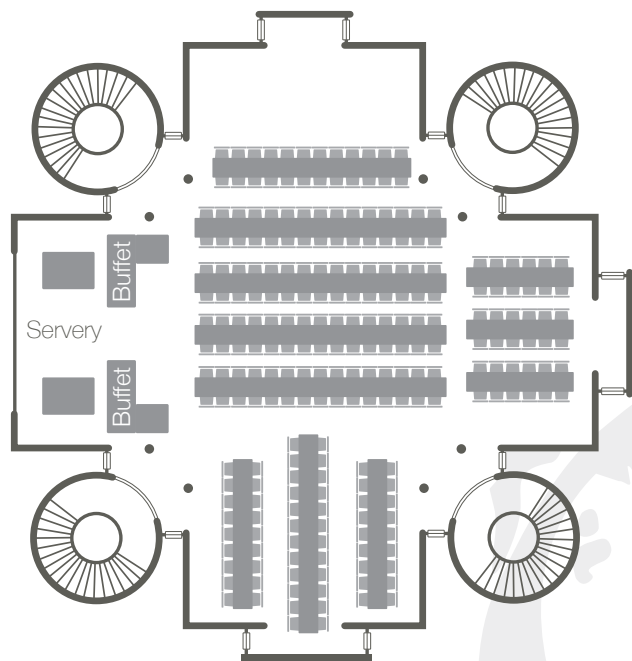

**Standing buffet 400**

*or drinks reception no top table*

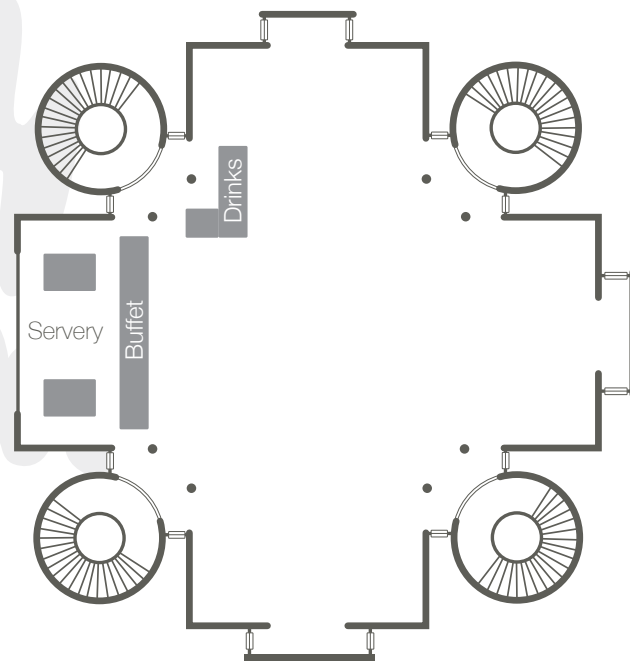

**Seated buffet 210**  
*with dancefloor and bar*

*no top table*

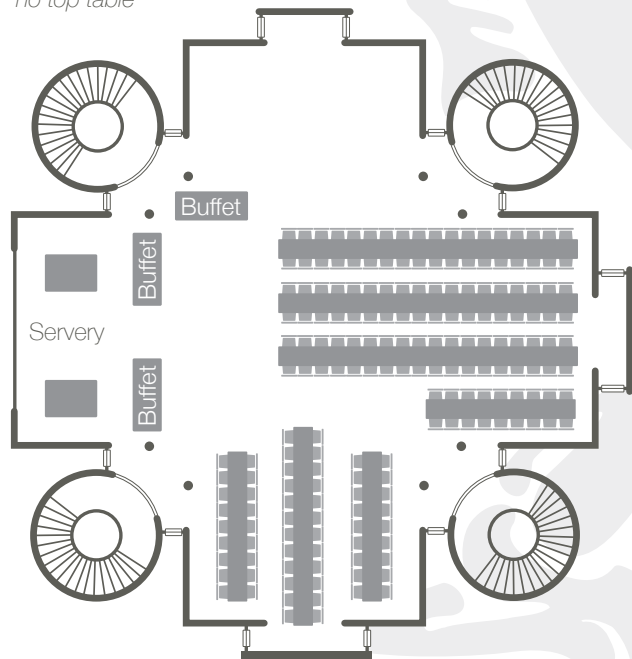

**Cabaret 140**

*with top table*

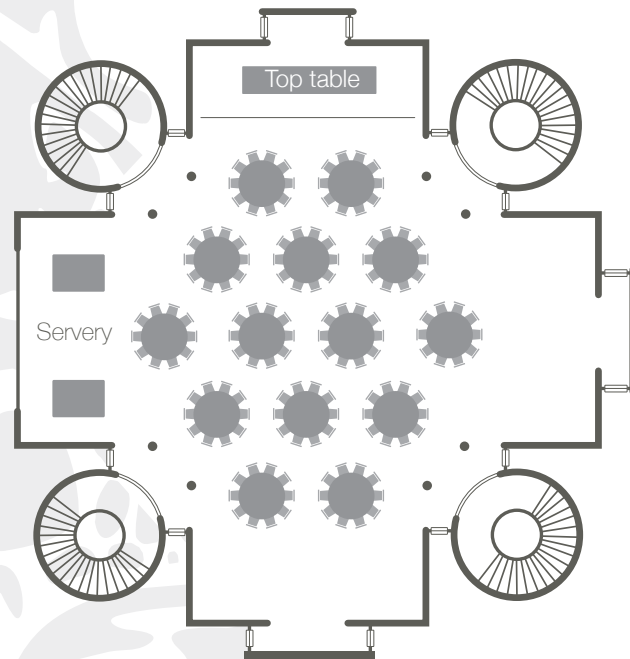

*Please contact us for more information on booking these rooms*

[events@murrayedwards.cam.ac.uk](mailto:events@murrayedwards.cam.ac.uk)  
[www.murrayedwardsevents.com](http://www.murrayedwardsevents.com)

Alternative room layouts - part 2

**Cabaret 140**  
with rising servery  
*with top table*

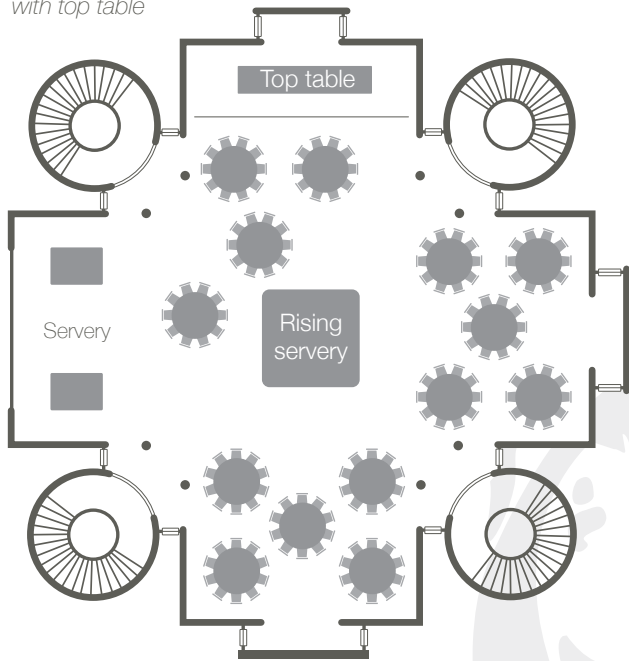

**Banquet 270**  
*with top table*

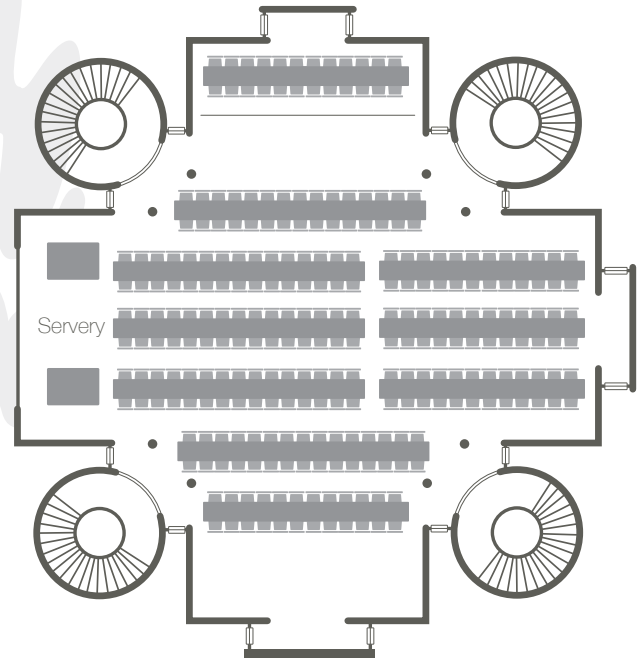

**Banquet 210**  
with dance floor and bar  
*no top table*

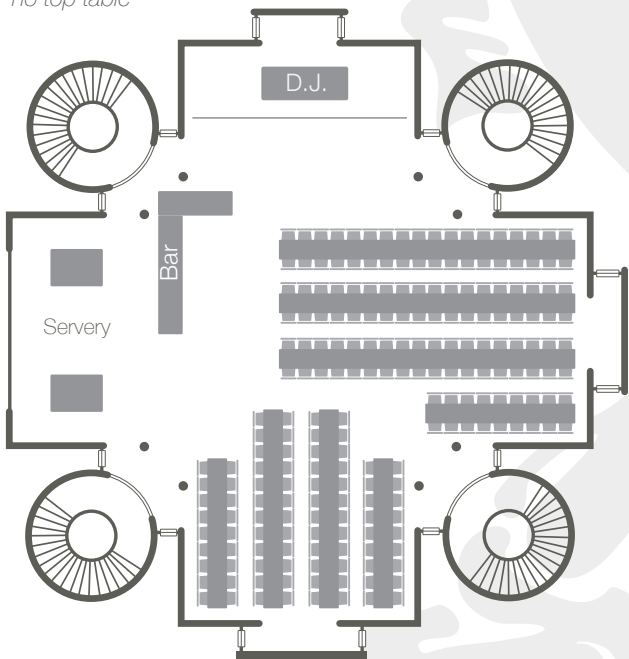

*Please contact us for more information  
on booking these rooms*

[events@murrayedwards.cam.ac.uk](mailto:events@murrayedwards.cam.ac.uk)  
[www.murrayedwardsevents.com](http://www.murrayedwardsevents.com)

## Alternative room layouts - part 3

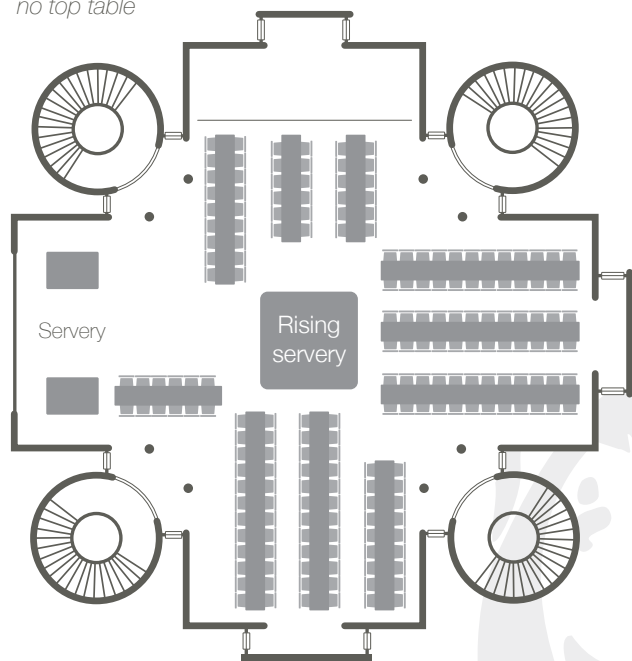
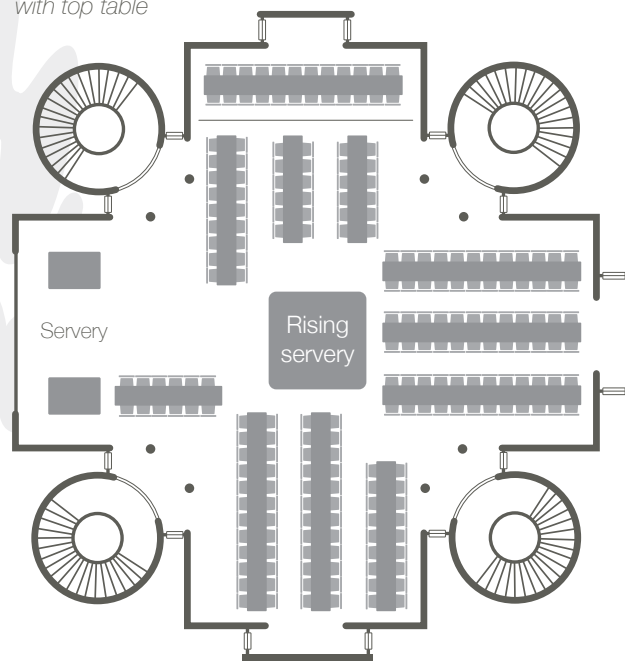
Banquet 192  
with rising servery*no top table*Banquet 216  
with rising servery*with top table*

*Please contact us for more information  
on booking these rooms*

[events@murrayedwards.cam.ac.uk](mailto:events@murrayedwards.cam.ac.uk)  
[www.murrayedwardsevents.com](http://www.murrayedwardsevents.com)

## Parking

70 parking spaces are available at our car park accessed via Storeys' Way. Spaces are on a first-come, first-served basis.

## Location

The Dome is located within the main College.

A detailed College map is available on our website, or from the Porters' Lodge.

## Fire Assembly Point

In the unlikely event of a fire, please note the Fire Assembly Point is on the front entrance, near the Porters' Lodge.

## Other information

This room is fully accessible.