



Murray Edwards College
University of Cambridge



Fellows' Dining and Drawing Rooms

An all-inclusive space, perfect for intimate dinners for 30 or larger celebrations for up to 70 guests. The adjoining drawing room is an attractive room for drinks receptions or, in the summer months, these can be taken outside in the Fellows' Garden.

- Light switches
- A.V. point
- Double plug socket
- Single plug socket
- Telephone
- Entrance doors

Cabaret style 40

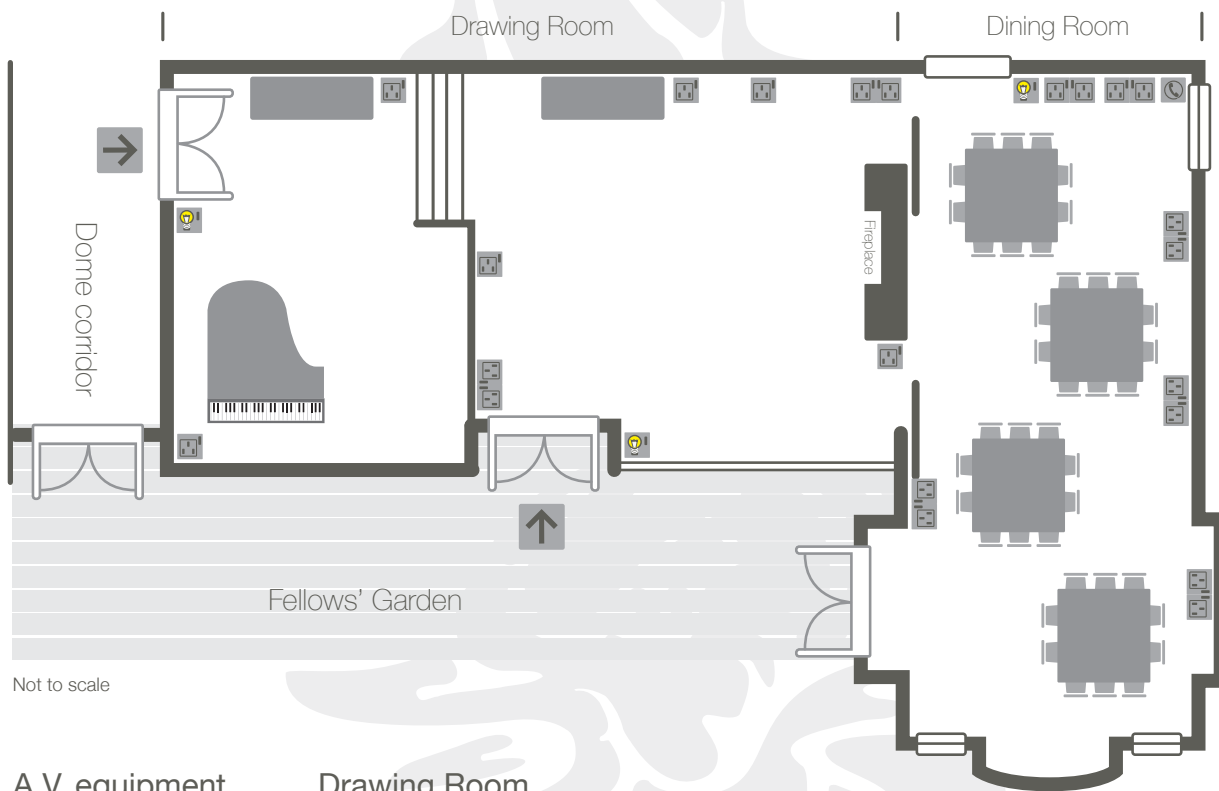

Not to scale

A.V. equipment
Portable projector, screen and audio are available.

Drawing Room
14m x 8m (112m²)

Dining Room
13.5m x 6m (81m²)

see reverse for additional layout options

Alternative room layouts

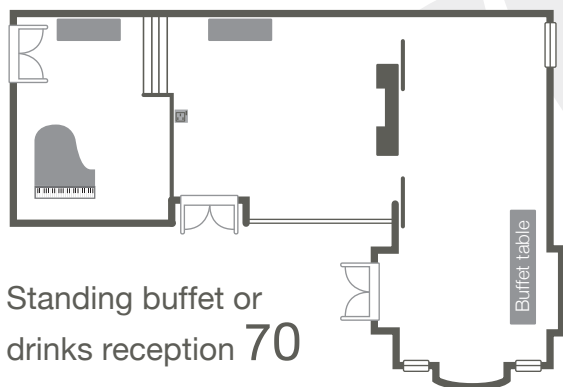
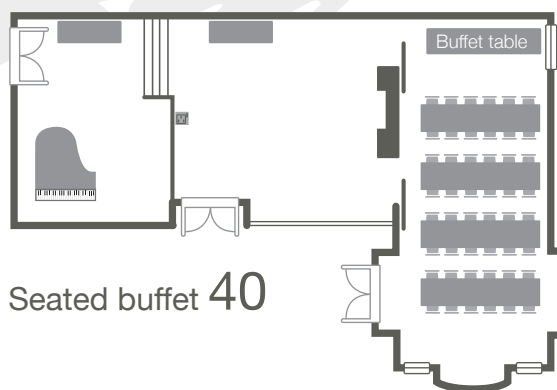
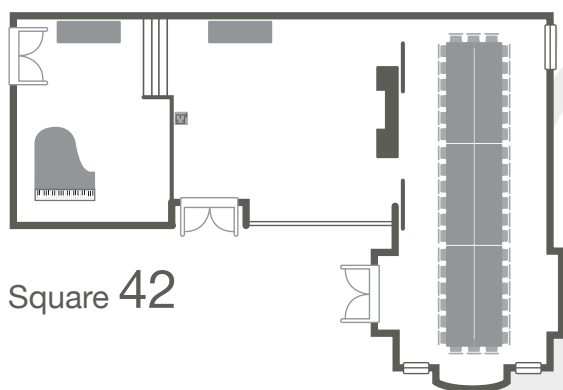
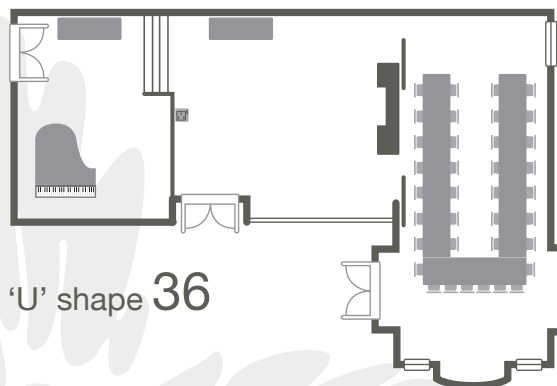
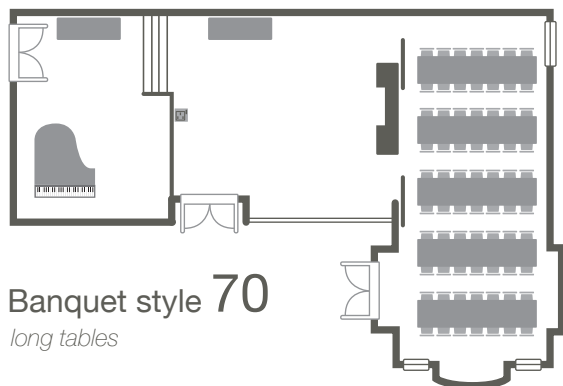

*Please contact us for more information
on booking these rooms.*

events@murrayedwards.cam.ac.uk
www.murrayedwardsevents.com



Parking

70 parking spaces are available at our car park accessed via Storeys' Way. Spaces are on a first-come, first-served basis.



Location

The Fellows' Dining Room is located past the entrance to the Dome on the ground floor.

A detailed College map is available on our website, or from the Porters' Lodge.



Fire Assembly Point

In the unlikely event of a fire, please note the Fire Assembly Point is on the front entrance, near the Porters' Lodge.



Other information

These rooms have stepped access.
Level access is provided via the Fellows' Garden.