



**Murray Edwards
College**

University of Cambridge

The Dome Dining Hall

A stunning space that will make your guests say “wow”. This room can be set up in banquet or cabaret style and can include a dance floor and bar, depending on your numbers.

Cabaret 80
with dancefloor and bar
no top table

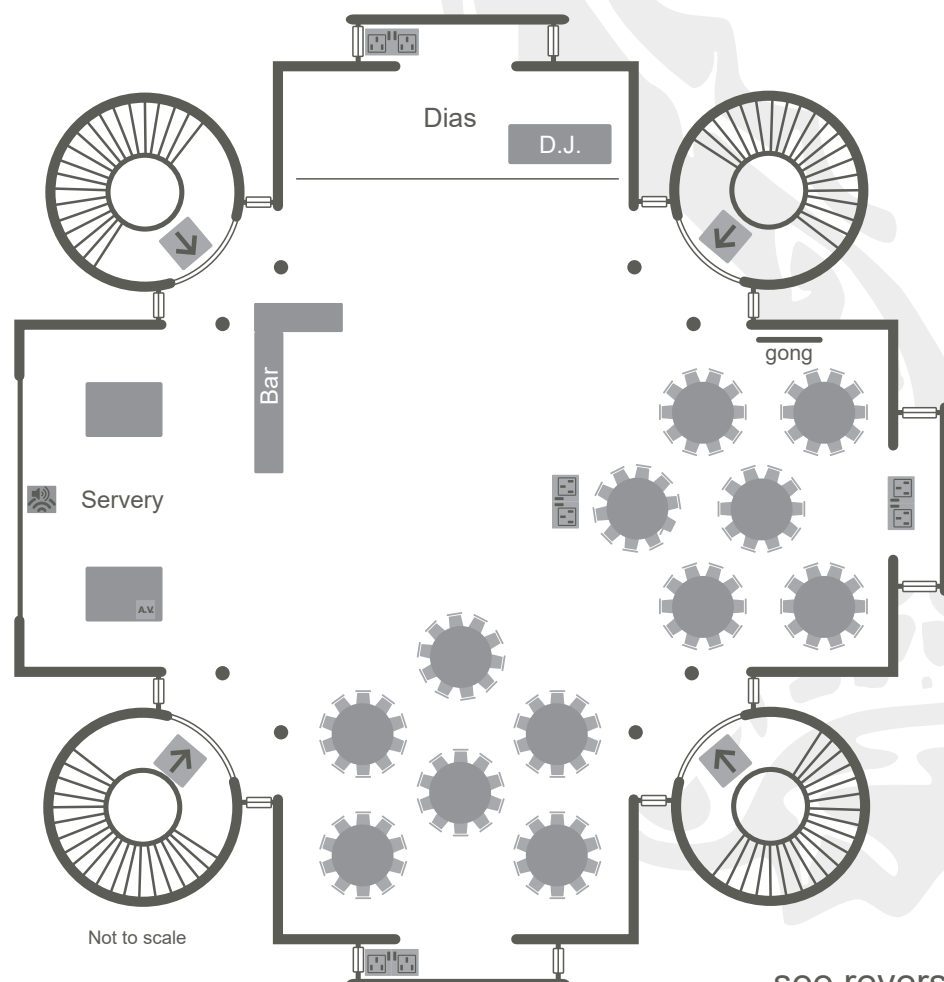

A.V. equipment

Portable projector,
screen and audio
are available
Microphones
Speakers for music
Noise control system

Room Area

320m²

KEY

- Light switches
- A.V. point
- Double plug socket
- Single plug socket
- Pillar
- Entrance door
- Sound limiter

see reverse for additional layout options

Alternative room layouts

Seated buffet 240
with top table

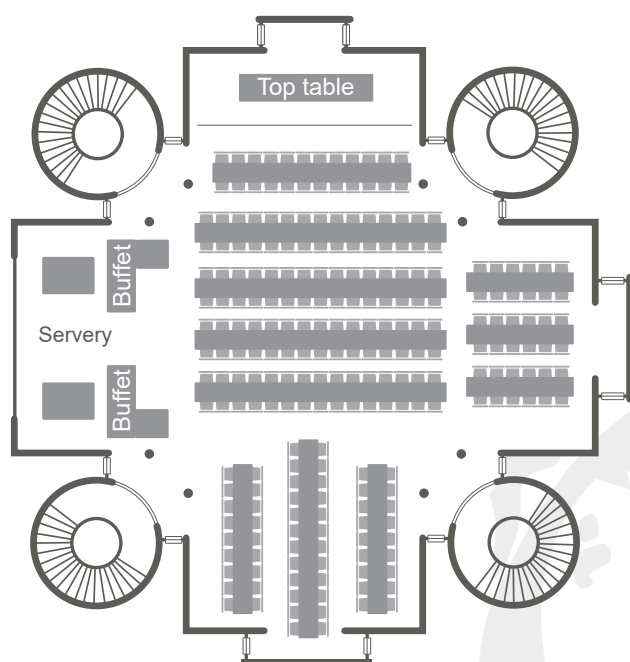

Standing buffet or drinks reception 300

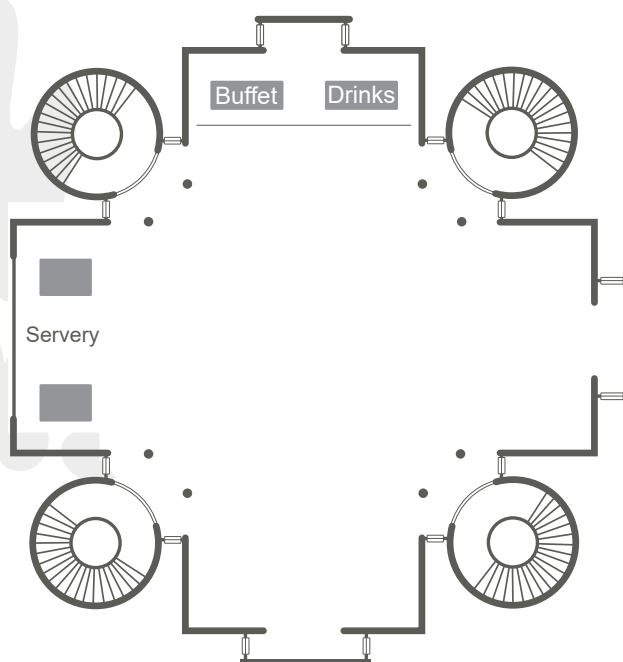

Seated buffet 210
no top table

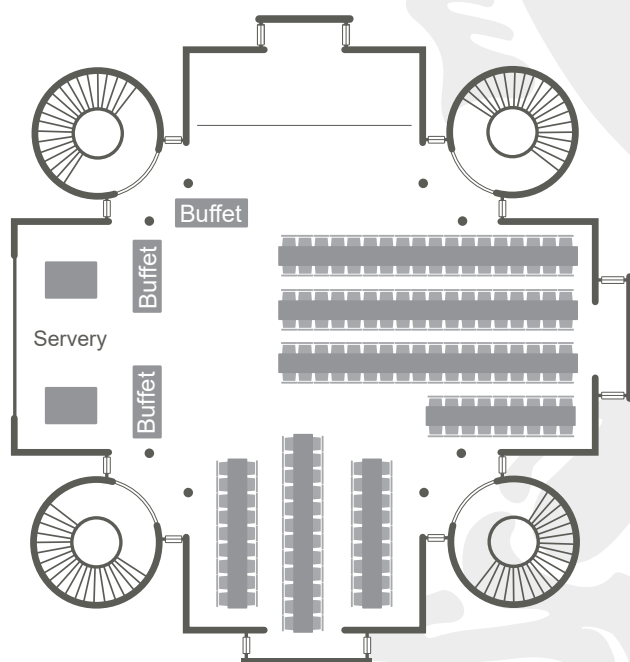

Cabaret 164
with top table

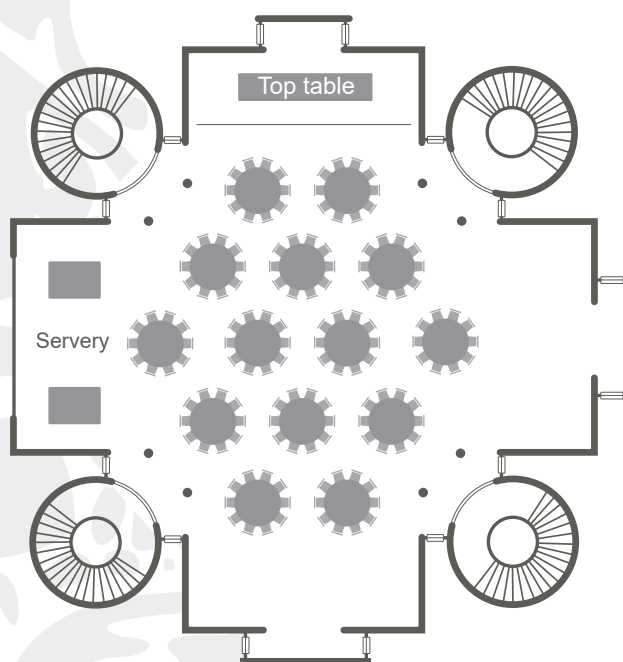

*Please contact us for more information
on booking these rooms.*

events@murrayedwards.cam.ac.uk
www.murrayedwardsevents.com

Alternative room layouts

Banquet 210
with dance floor and bar
no top table

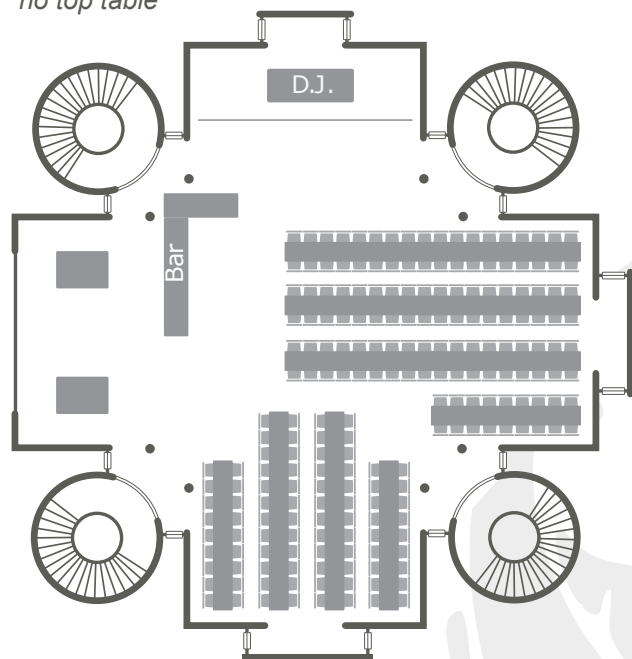

Banquet 270
with top table

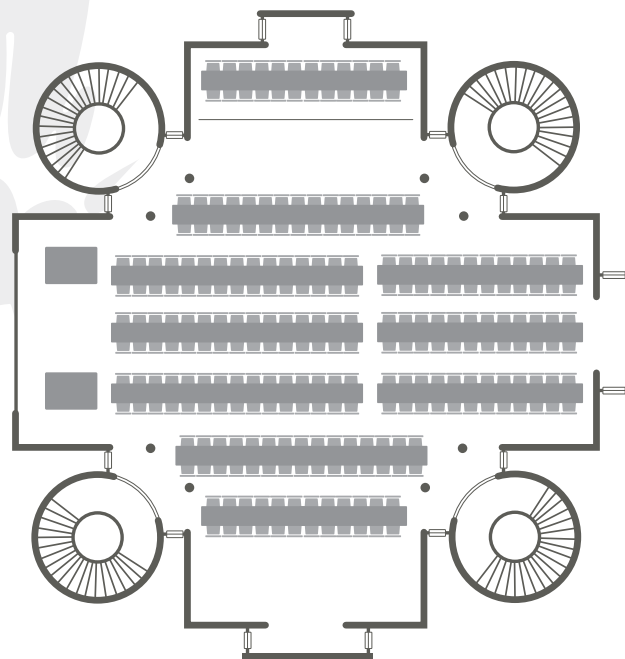

*Please contact us for more information
on booking these rooms.*

events@murrayedwards.cam.ac.uk
www.murrayedwardsevents.com

Parking

70 parking spaces are available at our car park accessed via Storeys' Way. Spaces are on a first-come, first-served basis.

Location

The Dome is located within the main College.

Fire Assembly Point

In the unlikely event of a fire, please note the Fire Assembly Point is on the front entrance, near the Porters' Lodge.

Other information

This room is fully accessible.

A detailed College map is available on our website, or from the Porters' Lodge.