



**Murray Edwards
College**

University of Cambridge



Buckingham House Lecture Theatre

This raked theatre seats 140 delegates and has high standard A.V. technology. A comfortable and well-presented room for presentations and lectures; there is a low stage with lectern and space for panels or top tables.

AV can be controlled via the lectern, from the rear of the room and by our on site technician from our AV office. There is space at the rear of the lecture theatre for translation booths and we can provide equipment for voting or additional screens for Twitter feeds – our technician would be delighted to discuss

Theatre style 140

A.V. equipment

HD projector
Fixed screen
Stereo ceiling speakers
Mics: 2 x hand, 2 x lapel,
4 x table, goose-neck on
lecterns
Sound and HD visual
recording
Wi-Fi is available
A second lectern is
available
Induction Loop

Room dimensions

13 m x 11 m (143m²)
4 spaces designated
for wheelchair users
by arrangement

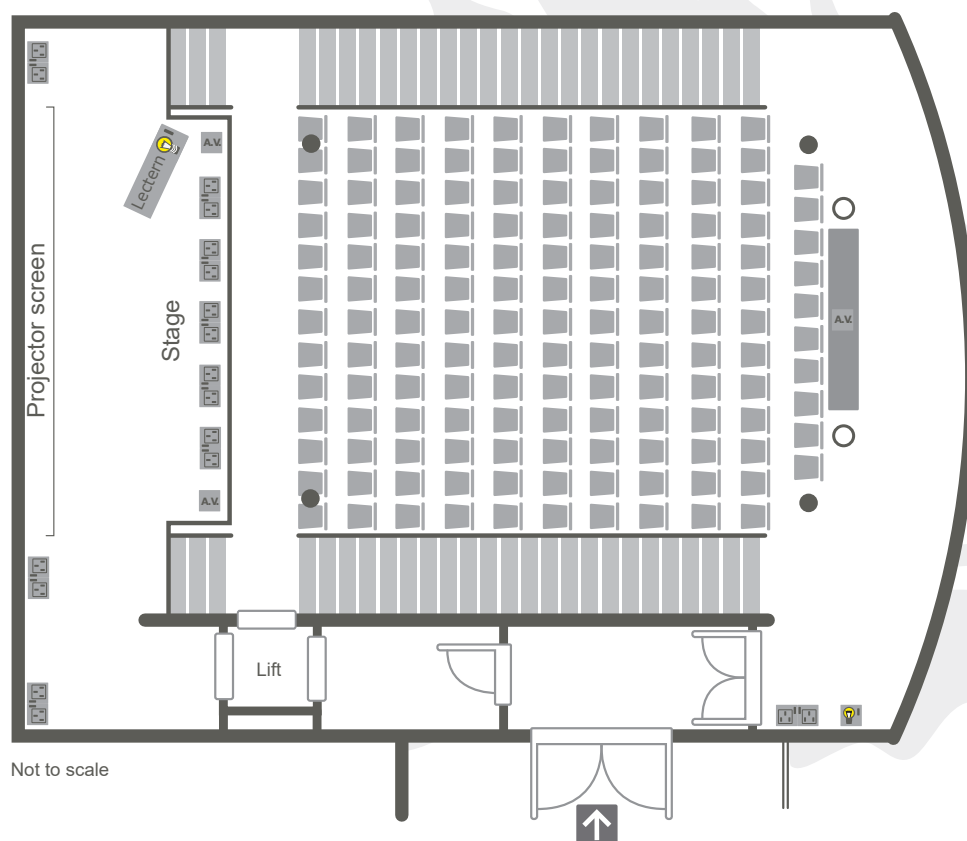

Not to scale

Buckingham House Foyer

KEY

- Light switches
- A.V. point
- Double plug socket
- Single plug socket
- Telephone
- Designated for wheelchair users
- Entrance door
- Pillars

Rooms also available in Buckingham House



Seminar Rooms 1 & 2

This versatile room can be divided into 2 soundproof meeting rooms and can be set up as an overflow for Buckingham House Lecture Theatre. This room has direct access to the deck and foyer and plenty of natural daylight, alongside black-out blinds for very bright days. Seating 36 people cabaret style, this room is a great space for allowing ideas to flow in workshops.



Syndicate Rooms 1 & 2

Located on levels one and two of Buckingham House, accessible by stairs or lift, these bright, intimate meeting rooms are suitable for up to 22 delegates. They can be set up with standard portable A.V. equipment, if required. Available in vacations only.

Please contact us for more information on booking these rooms

events@murrayedwards.cam.ac.uk
www.murrayedwardsevents.com

Parking

70 parking spaces are available at our car park accessed via Storeys' Way. Spaces are on a first-come, first-served basis.

Location

The Lecture Theatre is located on the ground floor of Buckingham House.

A detailed College map is available on our website, or from the Porters' Lodge.

Fire Assembly Point

In the unlikely event of a fire, please note the Fire Assembly Point is on the front entrance, near the Porters' Lodge.

Other information

This room is fully accessible with access to front and rear of seating and the stage.